



**KIT #554LPK**  
**CONVERSION KIT FROM NATURAL GAS TO LPG FOR**  
**MODEL 530AN**

**WARNING**

**This conversion kit shall be installed by a qualified service agency in accordance with the manufacturer's instructions and all applicable codes and requirements of the authority having jurisdiction. If the information in these instructions is not followed exactly, a fire, explosion or production of carbon monoxide may result causing property damage, personal injury or loss of life. The qualified service agency is responsible for the proper installation of this kit. The installation is not proper and complete until the operation of the converted appliance is checked as specified in the manufacturer's instructions supplied with the kit.**

**This conversion kit shall be installed by a qualified service agency.**  
**Caution: The gas supply shall be shut off before proceeding with the conversion.**

**Rating** Maximum 19,000 Btu/hr  
 Minimum 10,200 Btu/hr

**Kit Contents**

- 1 Pilot injector (Marked 25)
- 1 Burner unit including injector marked 200 (See figure 1 for identification)
- 1 Special bit for control cover screw
- 1. Set of conversion labels

**This appliance is certified for use from 0-4500ft. For altitudes above 4500ft see local codes**

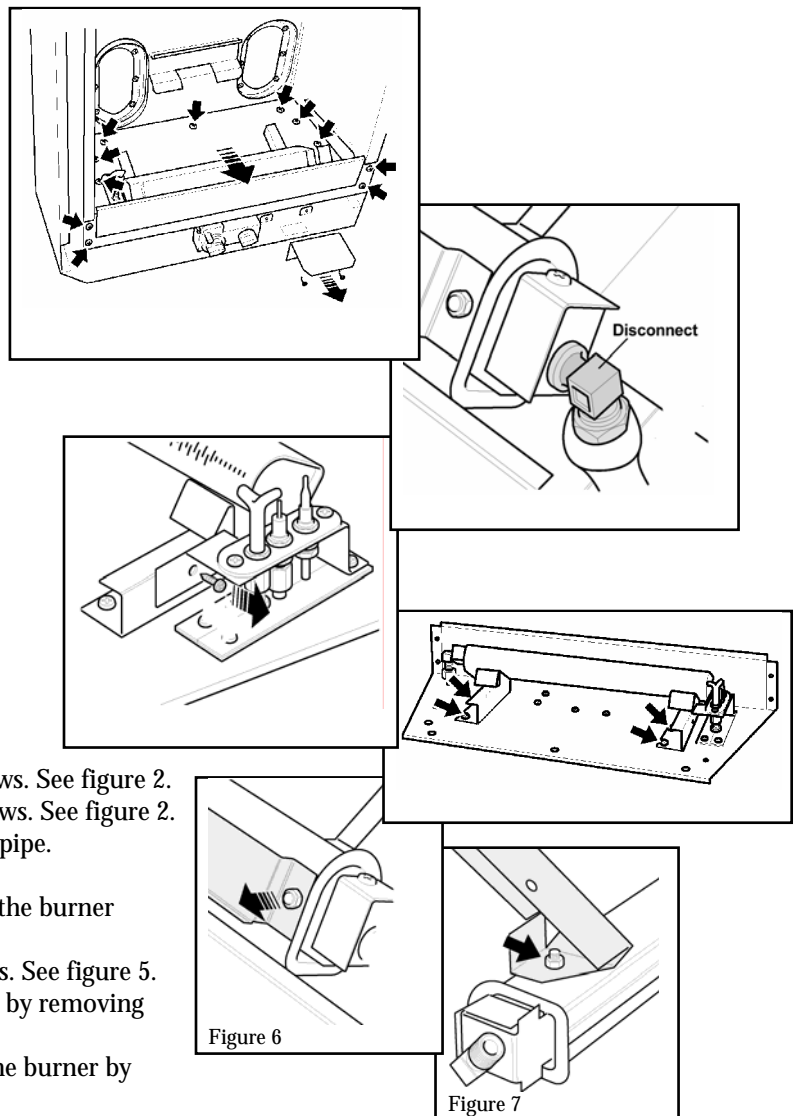
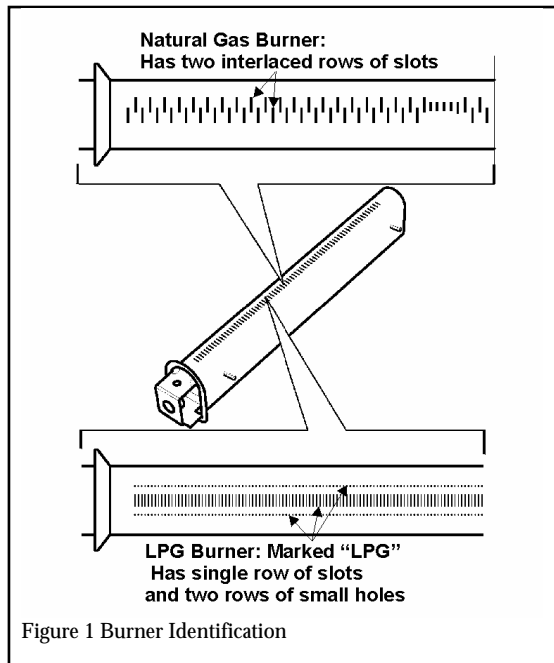

**Conversion Procedure**

1. Detach the battery shield by removing two screws. See figure 2.
2. Detach the burner module by removing 11 screws. See figure 2.
3. Disconnect the burner elbow injector from the pipe. See figure 3.
4. Remove the screw securing the pilot bracket to the burner support bracket. See figure 4.
5. Detach the burner unit by removing four screws. See figure 5.
6. Detach the log support bracket from the burner by removing two nuts. See figure 6.
7. Detach the two burner support brackets from the burner by removing two nuts. See figure 7.

8. Disconnect the pilot unit from its bracket by removing two screws. See figure 8.
9. Disconnect the pilot pipe. See figure 9.
10. Remove the pilot injector. Replace with LPG injector. See figure 10.
11. Replace main burner with LPG burner assembly supplied and reassemble module.
12. Remove the valve control cover screw using the special bit provided. See figure 11.
13. Lever off the control cover using a screwdriver or similar. See figure 12.
14. Refit the module to the appliance. Refit the battery shield.
15. The aeration shutter for LPG is factory set at 1/8" (3.0 mm). Check this setting. See figure 13.
16. Check the pilot position relative to the burner. See figure 14. Check ignition spark (refer to main instructions).
17. Turn on gas supply and check for leaks using soap solution. The minimum and maximum gas supply pressure are 11" and 14" w.c. and can be verified using the inlet supply pressure test tapping. See figure 15.
18. Fit a manometer to the manifold pressure test tapping (See figure 15). Light the appliance. Check for leaks downstream of the valve. Adjust the manifold pressure setting screw (See figure 16) to 10.5" w.c.
19. Turn appliance off. Remove the manometer and tighten the test tapping screw. Refit the control cover.
20. Fit the data conversion label and signed conversion label close to the rating plate. Fit the control conversion label near the controls.
21. Check that the appliance operates correctly. Refer to main instructions. If necessary (rarely required) adjust the aeration shutter as described in the appliance instructions.

